



FD AND FV SERIES FLUFF BLOWERS

FD and FV conveying systems are used to convey ground film scrap to the fluff feed unit or storage tank. FD Series fluff blowers feature direct drive motors, and FV Series blowers feature belt drive motors. The S Series cyclones can be used with fluff feed hoppers or fluff storage tanks.

STANDARD FEATURES

- High-performance blowers and cyclones designed for fluff
- Choice of 230/3/60 or 460/3/60 operating voltages
- Direct drive (FD) or belt drive (FV) blower motors

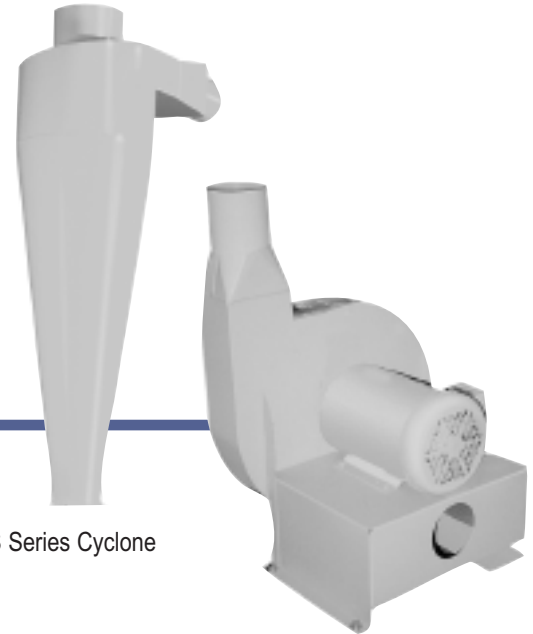

S Series Cyclone

Fluff Conveying Blower

OPTIONAL FEATURES

- Manual starter on blower
- Special voltage (please specify)

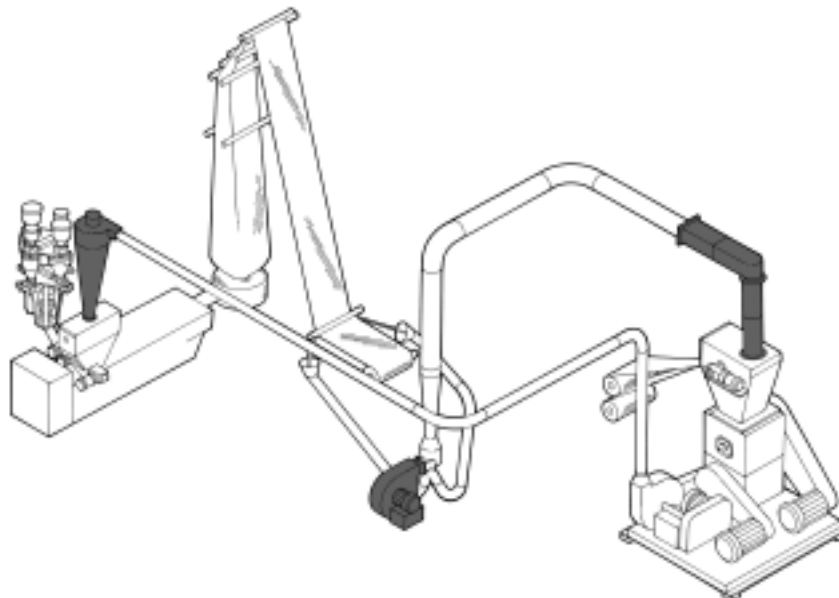

SPECIFICATIONS

Blower model	Blower power, HP (kW)	Airflow, cfm (cmh)	Tube dia. OD, in. (approx. mm)
4001FD	1(0.746)	545 (925)	4 (101.6)
4002FD	2 (1.492)	785 (1330)	4 (101.6)
5003FD	3 (2.238)	900 (1530)	5 (127.0)
5005FD	5 (3.730)	1100 (1870)	5 (127.0)
6075FD	7.5(5.595)	1400 (2380)	6 (152.4)
6075FV	7.5 (5.595)	1400 (2380)	6 (152.4)
7010FV	10 (7.460)	1770 (3,005)	7 (177.8)
8010FV6	15 (11.190)	2180 (3700)	8 (203.2)
10 (S4)	n.a.	300 (510)	3 (76.2)
12 (S5)	n.a.	545 (925)	4 (101.6)
13 (S6)	n.a.	785 (1330)	4 (101.6)
14 (S7)	n.a.	1100 (1865)	5 (127.0)
18 (S8)	n.a.	1400 (2375)	6 (152.4)
24 (S9)	n.a.	1770 (3005)	7 (177.8)
36 (S10)	n.a.	2180 (3700)	8 (203.2)

DIMENSIONS: S SERIES

Model no.	Inches																	
	A*	B*	C	D*	E	F	G	H	J*	K*	L*	M*	N	P	Q	R	S	T
10	9	3	2	4.5	2.5	4.5	22.375	31.875	4	6	0.25	5.125	5	4.5	4.75	3.5	9	4
12	12	4	4	5.75	3.5	3.5	31	43.5	4	6	0.25	5.125	6	4.75	4.75	4.5	12	4
13	15	4	5	8	4	5	32	47	6.75	9.5	0.313	8.5	12	5	5	12	15	4
14	18	5	5.75	9	4.75	5.75	42.125	60.25	6.75	9.5	0.313	8.5	12	5.75	5.75	12	18	4
18	24	8	9	12	5.625	9	57.25	81.25	8	10.438	0.375	9.5	16	9	9	16	24	5
24	28	9	10	14.5	7	10	68	96	10	13	0.375	11.75	14.5	10	10	14.5	28	5

Model no.	Centimeters																	
	A*	B*	C	D*	E	F	G	H	J*	K*	L*	M*	N	P	Q	R	S	T
10	22.9	7.6	5.1	11.4	6.4	11.4	56.8	80.9	10.2	15.2	0.64	13.0	12.7	11.4	12.1	8.9	22.9	10.2
12	30.5	10.2	10.2	14.6	8.9	8.9	78.7	110	10.2	15.2	0.64	13.0	15.2	12.1	12.1	11.4	30.5	10.2
13	38.1	10.2	12.7	20.3	10.2	12.7	81.3	119	17.1	24.1	0.8	21.6	30.5	12.7	12.7	30.5	38.1	10.2
14	45.7	12.7	14.6	22.9	12.1	14.6	107	153	17.1	24.1	0.8	21.6	30.5	14.6	14.6	30.5	45.7	10.2
18	60.9	20.3	22.9	30.5	14.3	22.9	145	206	20.3	26.5	0.95	24.1	40.6	22.9	22.9	40.6	60.9	12.7
24	71.1	22.9	25.4	36.8	17.8	25.4	173	244	25.4	33.0	0.95	29.9	36.8	25.4	25.4	36.8	71.1	12.7

* Diameter

